

### Included Components

1. CTSR x1
2. 1/4" to 1/4" Audio Cable x1
3. Antennas x2
4. MREWD Rack Kit x1
5. Antenna Plugs x2
6. Power Supply x1
7. Quick Start Guide x1

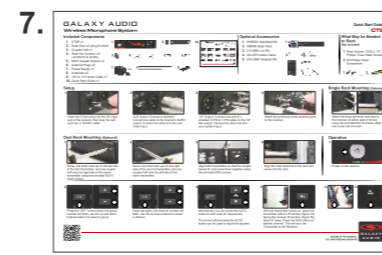
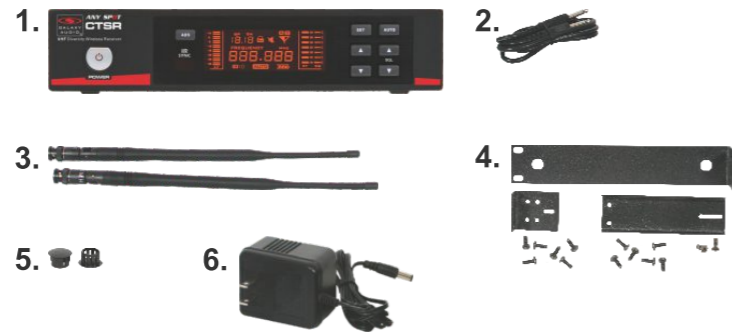

### Optional Accessories

1. HH85 Handheld Mic
2. MBP85 Body Pack
3. LV-U3BK Lav Mic
4. AS-GTR Guitar Cable
5. HS-U3BK Headset Mic



### What May be Needed to Rack (Not Included)

1. Rack Screws 10/32 x .75", Phillips Truss Head Screws
2. #2 Phillips Head Screwdriver



### Setup



1 Insert the 5.5mm plug into the DC input jack of the receiver, then plug the wall wart into a 120VAC outlet.



2 XLR Output: Connect a shielded microphone cable to the channel's XLRM output. Connect the other end into your mixer input.



3 1/4" Output: Connect one end of a shielded 1/4"M to 1/4"M cable, to the 1/4" Mix output. Connect the other end into your system input.



5 Attach the antennas to the antenna jacks on the receiver.

### Single Rack Mounting (Optional)

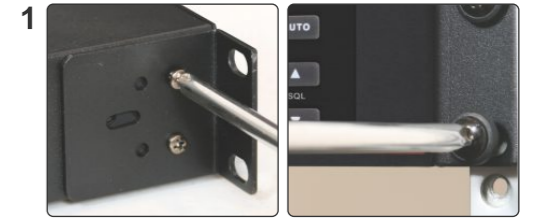

1 Attach the long and short rack ears to the receiver on either side of choice, using the provided M3/10 pan head screws. Align and screw into the rack.

### Dual Rack Mounting (Optional)



1 Screw one short rack ear on the left side of the first transmitter, and one coupler half onto the right side of the same transmitter using the provided M3/10 sized pan head screws.

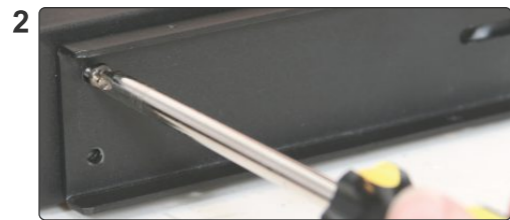

2 Screw one short rack ear on the right side of the second transmitter, and one coupler half onto the left side of the same transmitter.



3 Align both transmitters so that the coupler halves fit, and screw them together using the provided M3/5 counter sunk coupler screws.



4 Align the dual receivers to the rack and screw into the rack.

### Operation



1 Power on the receiver



2 Press the "SET" button twice, the group number will flash, use the up and down buttons below it to select a group.



3 Press set again, the channel number will flash, use the up down buttons to select a channel.



4 Alternatively, you can press the AUTO button to auto scan for frequencies. The arrow buttons below the AUTO button can be used to adjust the squelch.



5 With the transmitter turned on, place the transmitter with it's IR window (figure 5a) facing the receiver IR window (figure 5b), about 6" away. Press the ADS button. This will sync the Transmitter to the Receiver's group and channel.

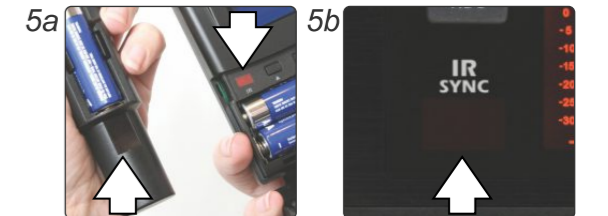



FAQ

- 1. Q. How do I access all 920 frequencies?**  
A. Press set, use the up/down arrows to go to group U or IU, press set again, use the up/down arrows to choose a channel, press set again, the first 3 frequency digits will start flashing, use the up down to select the desired MHz, hit set again and the next 3 digits will flash, use the up down to select the desired kHz, press set two more times to set and exit.
- 2. Q. How do I create a user group?**  
A. The user groups are already there labeled U and UI, you just need to set the frequencies, see above!
- 3. Q. How does the scan feature work?**  
A. When pressed, the auto scan will scan the current group setting to see how many channels are clear to use within that group. After it scans, it will show a number corresponding to the number of clear channels in that group. Using the up down arrow keys, you can select one of those clear channels. If the scans shows there are no, or very few open channels, select another group and repeat the scan procedure.
- 4. Q. I have multiple CTS systems, how should I set up their frequencies.**  
A. Start with all transmitters off, use the scan function on the first receiver to find a clear channel, turn on its transmitter and use the ADS function to sync them. Leaving the first transmitter on, move to the second system, and repeat the process. Continue this process till you have programmed all of your systems.
- 5. Q. I have other systems that are not Galaxy, how do I coordinate frequencies with those.**  
A. Turn on all of the transmitters of your other systems before beginning the scan process with your CTS systems.
- 6. Q. We have a lot of wireless systems and are having trouble getting the frequencies coordinated even using the scan function.**  
A. Contact our service dept. at [service@galaxyaudio.com](mailto:service@galaxyaudio.com), we will be glad to assist you.



MAKERS OF THE ORIGINAL  
HOT SPOT PERSONAL MONITOR

**BE HEARD™**

Other Helpful Sources

CTS  
Product Page



CTS  
Manual



(PDF Download)

CTS  
Cutsheet



(PDF Download)

CTS  
How To Video



Wireless Tips

- Maintain line of sight between the transmitter and receiver antennas.
- Do not have walls, metal objects, large crowds, etc. blocking the line of sight between the transmitter and receiver.
- Antennas on the stationary equipment should be kept several feet above the ground.
- Antennas can be mounted on stands or walls using brackets such as the ANT-LB.
- On body pack receivers/transmitters, avoid putting them in your pocket, and/or folding the antenna under the pack. The antenna should hang freely and openly.
- Keep the distance between transmitters and receivers as short as possible.
- If distances above 20-30' are unavoidable, directional antennas such as the ANT-PDL can improve reception by rejecting signals outside their pickup angle.
- Find out what TV stations are broadcasting in your area and avoid the channels they are on.
- This information is available from many sources on line, such as [www.tvfool.com](http://www.tvfool.com).
- If your receiver is showing that it is receiving RF when your transmitter is turned off, you need to move to another frequency.
- If you are using several systems, you can contact [service@galaxyaudio.com](mailto:service@galaxyaudio.com) for assistance in frequency coordination.

Make certain you are using fresh batteries, rechargeable batteries may be used, but they discharge at a much faster rate than alkaline.

Specifications subject to change without notice.